

# CITY OF NAPOLEON RESIDENTIAL ZONING PERMIT APPLICATION

THIS APPLICATION IS FOR RESIDENTIAL DEMOLITIONS, FENCES, POOLS, SHEDS,  
DRIVEWAYS, SIDEWALKS & SEWERS

OK PD  
P-14-0138  
2014  
Res.

DATE 5/6/2014 JOB LOCATION 205 Orchard Ln

OWNER Clayton & Ashlee Brink TELEPHONE # 419-966-7580

OWNER ADDRESS 205 Orchard Ln

CONTRACTOR \_\_\_\_\_ CELL PHONE # \_\_\_\_\_

DESCRIPTION OF WORK TO BE PERFORMED Fence & move shed

ESTIMATED COMPLETION DATE \_\_\_\_\_ ESTIMATED COST \_\_\_\_\_

DESCRIPTION	FEE	TOTAL COST
Demo Permit	(100.3100.46690) \$100.00	\$
Fence	(100.3100.46690) \$25.00	\$
Pool	(100.3100.46690) \$25.00	\$
Garage and Shed Under 200 SF (Detached)	(100.3100.46690) \$25.00	\$ <u>25.00</u>
Driveway	0	\$
Sidewalk/Curbing	0	\$
Sewer Outside	0	\$
<b>Subtotal:</b>		\$
		\$
<b>TOTAL FEE:</b>	\$ <u>25.00</u>	

**I FULLY UNDERSTAND THAT NO EXCAVATION, CONSTRUCTION OR STRUCTURAL ALTERATION, ELECTRICAL OR MECHANICAL INSTALLATION OR ALTERATION OF ANY BUILDING STRUCTURE, SIGN, OR PART THEREOF AND NO USE OF THE ABOVE SHALL BE UNDERTAKEN OR PERFORMED UNTIL THE PERMIT APPLIED FOR HEREIN HAS BEEN APPROVED AND ISSUED BY THE CITY OF NAPOLEON BUILDING/ZONING DEPARTMENT.**

*I hereby certify that I am the Owner of the named property, or that the proposed work is authorized by the Owner of record and that I have been authorized by the Owner to make this application as his/her authorized agent and I agree to conform to all applicable laws of the jurisdiction. In addition, if a permit for Work described in this application is issued, I certify that the code official or the code official's authorized representative shall have the authority to enter areas covered by such permit at any reasonable hour to enforce the provisions of the code(s) applicable to such permit.*

**I HEREBY ACKNOWLEDGE THAT I HAVE READ AND FULLY UNDERSTAND THE ABOVE LISTED INSTRUCTIONS.**

SIGNATURE OF APPLICANT: Ashlee Brink DATE: 5/6/2014

PRINT NAME: Ashlee Brink

PERMIT # \_\_\_\_\_ BATCH # 30016 CHECK # Cash DATE 5-6-14

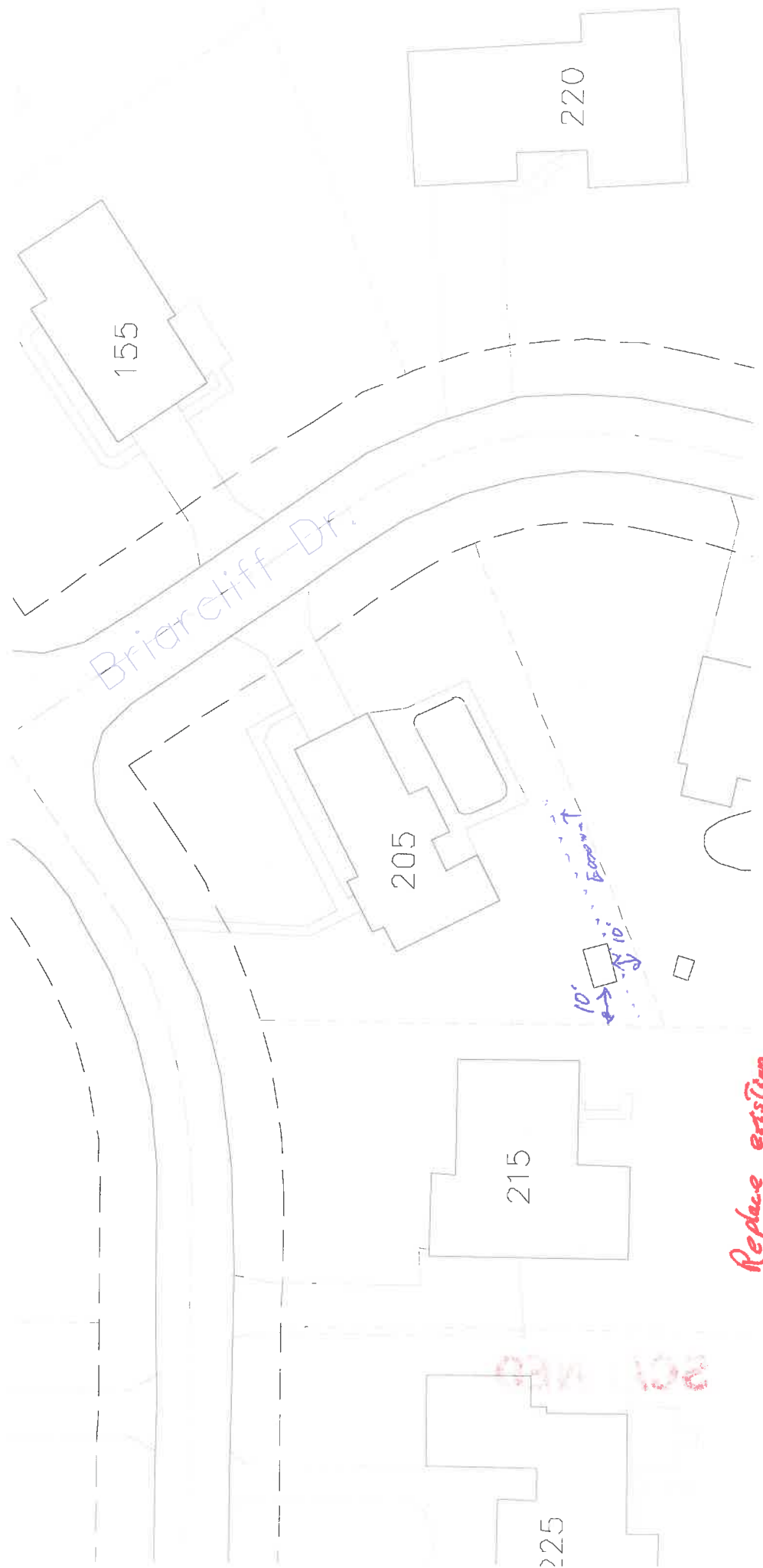

Replace existing  
shed with a 10'x14'  
10'x10'

201 MB